

VALVULA DE MEMBRANA
CLAMP/CLAMP
Aisi 316L

Ref. KL-10

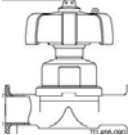

DN: 1/2", 3/4", 1", 1 1/2", 2"

VALVULA DE MARIPOSA
CLAMP /CLAMP
Aisi 316L

Ref. 4012

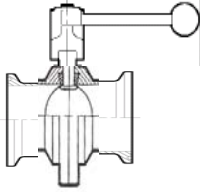

DN: 1", 1 1/2", 2", 2 1/2", 3", 4", 6"

VALV. DE BOLA SANITARIA
CLAMP/CLAMP

Ref. K-90

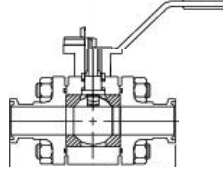

DN: 1/2", 3/4", 1", 1 1/2", 2", 2 1/2", 3", 4"

VALV.DE BOLA DRENAJE
CLAMP/ CLAMP

Ref. K-51B



DN: 1/2", 3/4", 1", 1 1/2", 2", 2 1/2", 3", 4"

ABRAZADERA CLAMP
Aisi 304L

Ref. K12
Ref. K12D

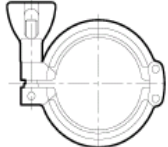

K12 DN: 1/2", 3/4", 1", 1 1/2", 2", 3", 4"
K12 D NW: 10/20, 25/40, 50, 65, 80, 100, 125, 150

ABRAZADERA CLAMP
ALTA PRESION
Aisi 304L

Ref. K 13 MHP

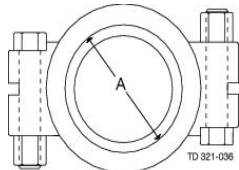

DN: 1", 1 1/2", 2", 2 1/2", 3", 4", 6"

ABRAZADERA CLAMP
Aisi 304L

K12 ISO

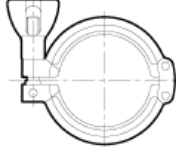

DN: 8-15, 20-25, 32-40, 50, 65, 80, 100, 125, 150, 200, 250

TAPON CIEGO CLAMP
Aisi 316L



DN: 8-15, 20-25, 32-40, 50, 65, 80, 100, 125, 150, 200, 250

CASQUILLO CLAMP
Aisi 316L

Ref. K14 W Standard BS 4825 S/Norma A270
Ref. K14 D (Acabado DIN/NW) Standard DIN 32676 S/ Norma 11850

TC

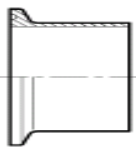

DN	TUBO	Long.	TC	NW	TUBO	Long.	TC
1/2"	12,7x1,65	28,0	25,0	10	12x1,5	18,0	34,0
3/4"	19,5x1,65	28,0	25,0	15	18x1,5	18,0	34,0
1"	25,4x1,65	28,6	50,4	20	22x1,5	18,0	34,0
1 1/2"	38,1x1,65	28,6	50,4	25	28x1,5	21,5	50,4
2"	50,8x1,65	28,6	64,0	32	34x1,5	21,5	50,4
2 1/2"	63,5x1,65	28,6	77,5	40	40x1,5	21,5	50,4
3"	76,2x1,65	28,6	91,0	50	52x1,5	21,5	64,0
4"	101,6x 2,11	28,6	119,0	65	70x2	28,0	91,0
6"	152,4x2,77	28,6	167,1	80	85x2	28,0	106,0
8"	203,2x2,77	28,6	217,5	100	104x2	28,0	119,0
10"	254,0x2,77	28,6	268,5	125	129x2	28,0	155,0
12"	304,8x2,77	28,6	319,8	150	154x2	28,0	183,0

CASQUILLO CLAMP

Ref. K14 AMP
Ref. K14 ISO

ASME BPE , PL Ra. 0,5 interno para Pharma
ISO 2852 fot tube std. According ISO 1127

TC

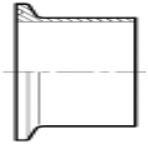

DN	TUBO	Long.	TC	ISO	TUBO	Long.	TC
1/2"	12,7x1,65	44,5	25,0	8	13,5X1,6	21,5	25,0
3/4"	19,5x1,65	44,5	25,0	10	17,2x1,6	21,5	25,0
1"	25,4x1,65	44,5	50,4	15	21,3x1,6	21,5	34,0
1 1/2"	38,1x1,65	44,5	50,4	20	26,9x1,6	21,5	50,4
2"	50,8x1,65	57,15	63,9	25	33,7x2,0	21,5	50,4
2 1/2"	63,5x1,65	57,15	77,5	32	42,4x2,0	21,5	64,0
3"	76,2x1,65	57,15	90,9	40	48,3x2,0	21,5	64,0
4"	101,6x 2,11	57,15	118,9	50	60,3x2,0	21,5	77,5
6"	152,4x2,11	76,20	166,68	65	76,1x2,0	21,5	91,0
				80	88,9x2,3	21,5	106,0
				100	114,3x2,3	28,5	144,4
				125	139,7x2,3	28,5	155,0
				150	168,3x2,6	28,5	183,0

PORTAMANGUERA CLAMP

PULIDO INT/EXT Ra 0,8
Aisi 316L

REF. K-14 RHA

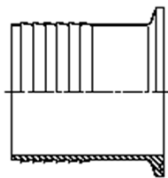

DN: 1/2", 3/4", 1", 1 1/2", 2", 2 1/2", 3", 4"

TAPON CIEGO CLAMP

PULIDO INT/EXT Ra 0,8
Aisi 316L

REF. K-16

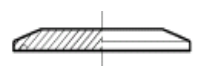

1/2", 3/4", 1", 1 1/2", 2", 2 1/2", 3"

CODO CLAMP

PULIDO INT/EXT Ra 0,8
Aisi 316L

Ref. KL-2 C

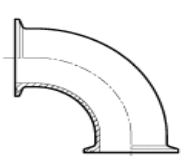

DN: 1/2", 3/4", 1", 1 1/2", 2", 2 1/2", 3", 4"

TE CLAMP

PULIDO INT/EXT Ra 0,8
Aisi 316L

Ref. 7

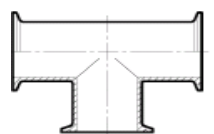

DN: 1/2", 3/4", 1", 1 1/2", 2", 2 1/2", 3", 4"

CODO CLAMP SOLDAR

PULIDO INT/EXT Ra 0,8
Aisi 316L

Ref. W 2 C



DN: 1/2", 3/4", 1", 1 1/2", 2", 2 1/2", 3", 4"

TE CLAMP SOLDAR

PULIDO INT/EXT Ra 0,8
Aisi 316L

Ref. W 7

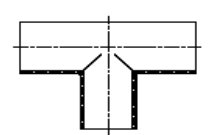

DN: 1/2", 3/4", 1", 1 1/2", 2", 2 1/2", 3", 4"